

**NOTES:**

1. PARCEL AREA: 1,487,644 SQ. FT. = 34.14 ACRES
2. NHDES SUBDIVISION APPROVAL NUMBER: SA2002003712 (10/28/2002)  
NHDES DREDGE & FILL APPROVAL NUMBER: 2001-02490  
NHDES SITE SPECIFIC APPROVAL NUMBER: WPS-6240 (JULY 11, 2002)  
NHDES WELL APPROVAL NUMBER: 993704 - HADLEIGH WOODS
3. THE MAJORITY OF THE SUBJECT PROPERTY LIES WITHIN THE 140 SCS SOILS GROUP AS SHOWN ON THE SCS MAP FOR THE TOWN OF WINDHAM, NH.  
140 - CHATFIELD-HOLLIS-CANTON COMPLEX
4. SYSTEM LOADING CALCULATION  
TOTAL NUMBER OF UNITS = 6 (UNITS BLACKBURN 3-5 & 6-8/HADLEIGH 26-28)  
TOTAL NUMBER OF PROPOSED BEDROOMS = (2 BDRMS/UNITS) 12 TOTAL  
12 BEDROOMS X 150 GPD/BEDRM. = 1,800 GPD  
PERCOLATION RATE; 8 MIN./INCH 42"  
NHDES MINIMUM LEACHING FIELD SIZE REQUIRED = 3,040 SQ. FT.  
ELJEN (TYPE "B") IN-DRAIN CALCULATION  
 $3.5 + [(8 \text{ MIN./INCH} \times 0.125)] \times 12 \text{ BDRMS} = 54 \text{ UNITS}$
5. USE (60) TYPE "B" ELJEN IN-DRAIN UNITS, DISTRIBUTED LOCALLY BY HUBER DESIGN, INC. P.O. BOX 401, 175 PETERBOROUGH ROAD HANCOCK, NEW HAMPSHIRE 03449, PHONE: (603) 525-4320 OR APPROVED EQUAL.
6. SEPTIC TANK: USE (1) 2,000 GALLON 2-COMPARTMENT PRECAST CONCRETE SEPTIC TANK, FOR EACH BUILDING. TANKS MANUFACTURED AND DISTRIBUTED BY NEW ENGLAND PRECAST CORP., ROUTE 110 - AMESBURY, MASS. 01913 PHONE: (800) 323-9487, OR APPROVED EQUAL.  
NOTE: EACH BUILDING WILL HAVE (1) 2,000 GALLON 2-COMPARTMENT TANK SEPTIC TANK.
7. DISTRIBUTION BOX: USE (1) 6 OUTLET PRECAST CONCRETE DISTRIBUTION BOX AS MANUFACTURED AND DISTRIBUTED BY ROTONDO & SONS, INC., OR APPROVED EQUAL.
8. ALL PIPES EXITING THE PROPOSED DISTRIBUTION BOX SHALL HAVE AN "EQUALIZER" FLOW DIVIDER INSTALLED (OR APPROVED EQUAL).  
"EQUALIZER" FLOW DIVIDERS ARE DISTRIBUTED LOCALLY BY HUBER DESIGN, INC.
9. INSTALL A ZABEL, MODEL A300, FILTER, OR APPROVED EQUAL, AT THE OUTLET OF EACH PROPOSED SEPTIC TANK. ZABEL FILTERS DISTRIBUTED BY ZABEL ENVIRONMENTAL TECHNOLOGY 10409 WATTSORON TR. LOUISVILLE, KY 40289-3701, PHONE: (800) 221-5742.
10. DESIGN INTENT: BOTTOM OF THE PROPOSED LEACHING FIELD SHALL BE 0.70 FEET ABOVE THE EXISTING GRADE ON THE UPSLOPE SIDE.
11. NEAREST GROUP 6 SOIL OR NEIGHBORING WELL ARE ALL GREATER THAN 100 FEET AWAY FROM THE PROPOSED SEPTIC SYSTEM.
12. PIPES LEADING TO AND EXITING FROM THE PROPOSED SEPTIC TANK AND DISTRIBUTION BOX SHALL BE SEALED WITH AN APPROVED METHOD AS TO MAKE THE JOINTS WATERTIGHT.
13. SHOULD FAILURE OCCUR THIS SYSTEM SHALL BE REBUILT IN-PLACE.
14. PIPES LEADING TO AND EXITING FROM THE PROPOSED SEPTIC TANK, PUMP CHAMBER AND DISTRIBUTION BOX SHALL BE SEALED WITH AN APPROVED METHOD AS TO MAKE THE JOINTS WATERTIGHT.
15. PRIOR TO THE START OF CONSTRUCTION ALL BENCHMARKS SHALL BE VERIFIED FOR ACCURACY.
16. FOUNDATION DRAINS: NO FOUNDATION DRAINS SHALL BE INSTALLED WITHIN 25 FEET OF THE PROPOSED SEPTIC SYSTEM OR WITHIN 10 FEET OF THE PROPOSED SEPTIC TANK.
17. NO GARBAGE DISPOSAL IS PROPOSED WITH THIS DESIGN.
18. INSTALLATION OF THE ELJEN IN-DRAIN SYSTEM SHALL BE IN STRICT ACCORDANCE WITH THE ELJEN IN-DRAIN DESIGN AND INSTALLATION MANUAL FOR THE STATE OF NEW HAMPSHIRE, REVISED JUNE 05, 1995.
19. JOINTS ARE TO BE BELLED PVC OR STANDARD SLIP COLLARS.
20. ALL LATERALS TO EXIT THE DISTRIBUTION BOX AT SAME ELEVATION.
21. 2' OF COVER SHALL BE PROVIDED OVER THE FIELD WHERE MOTOR VEHICLE TRAFFIC WILL PASS OVER THE SEPTIC SYSTEM FIELD. FILL SHALL NOT BE OF SATURATED SOIL.
22. ALL TREES, TOPSOIL, ROOTS, AND ORGANIC MATTER MUST BE REMOVED FROM THE AREA TO BE FILLED, OUT TO AND INCLUDING THE AREA UNDER THE IMPERMEABLE SOIL BARRIER. FILL MATERIAL TO BE CLEAN MEDIUM TO COARSE SAND, FREE OF TOPSOIL, HUMUS, DREDGINGS, OR STONES OVER 6" IN DIMENSION.
23. PROVIDE MEASURED TIES TO OWNER, ON THE LOCATION OF SEPTIC TANK ACCESS POINTS.
24. ANY DISCREPANCIES OR UNUSUAL CONDITIONS SHALL BE REPORTED TO THE DESIGNER BEFORE CONTINUING WITH THE INSTALLATION.
25. CONTRACTOR TO PROTECT BASE ELEVATION AREAS FROM SILTATION DURING CONSTRUCTION.
26. THERE SHALL BE A MINIMUM 4" OF LOAM SUITABLE FOR SEEDING AND PROPER STABILIZATION OF ALL DISTURBED AREAS.
27. WETLANDS FLAGGED ON-SITE BY:  
BLUE MOON, ENVIRONMENTAL, INC.  
PO BOX 368  
CONCORD, NEW HAMPSHIRE 03302  
PHONE: (603) 435-6163
28. ENV-WS 1023.01  
A) SEPTIC TANKS SHALL BE INSPECTED FOR ACCUMULATION OF SLUDGE AND SURFACE SCUM AT LEAST ONCE A YEAR.  
B) WHEN THE COMBINED THICKNESS OF THE SLUDGE AND SURFACE SCUM EQUAL 1/3 OR MORE OF THE TANK DEPTH, THE TANK SHALL BE PUMPED BY A LICENSED SEPTIC TANK PUMPER.
29. NHDES CONSTRUCTION APPROVAL WILL BE FOR ALL 3 BUILDINGS. CONTRACTOR SHALL NOT CALL FOR OPERATIONAL APPROVAL FOR THE PROPOSED SYSTEM UNTIL ALL 3 FOUNDATIONS, 3 SEPTIC TANKS AND COMMON FIELD ARE INSTALLED.
30. INSTALL "SWEET AIR" FILTERING DEVICES ON THE END OF EACH VENT PIPE. SWEET AIR FILTERS ARE DISTRIBUTED LOCALLY BY HUBER DESIGN, INC.
31. EXISTING WATER LINE WITHIN 25' OF THE PROPOSED LEACHING FIELD SHALL BE WITH A PIPE HAVING AN SDR 26 OR EQUIVALENT.  
WHERE WATER LINES CROSS SEWER LINES THE SEWER LINE SHALL BE A MINIMUM OF 18 INCHES BELOW THE WATER LINE, OR UNLESS THE WATER LINE IS ENCASED IN CONCRETE OR A PIPE HAVING AN SDR OF 26 FOR A DISTANCE OF 10 FEET TO EITHER SIDE OF THE SEWER LINE. (NHDES ENV-WS 1009.01)

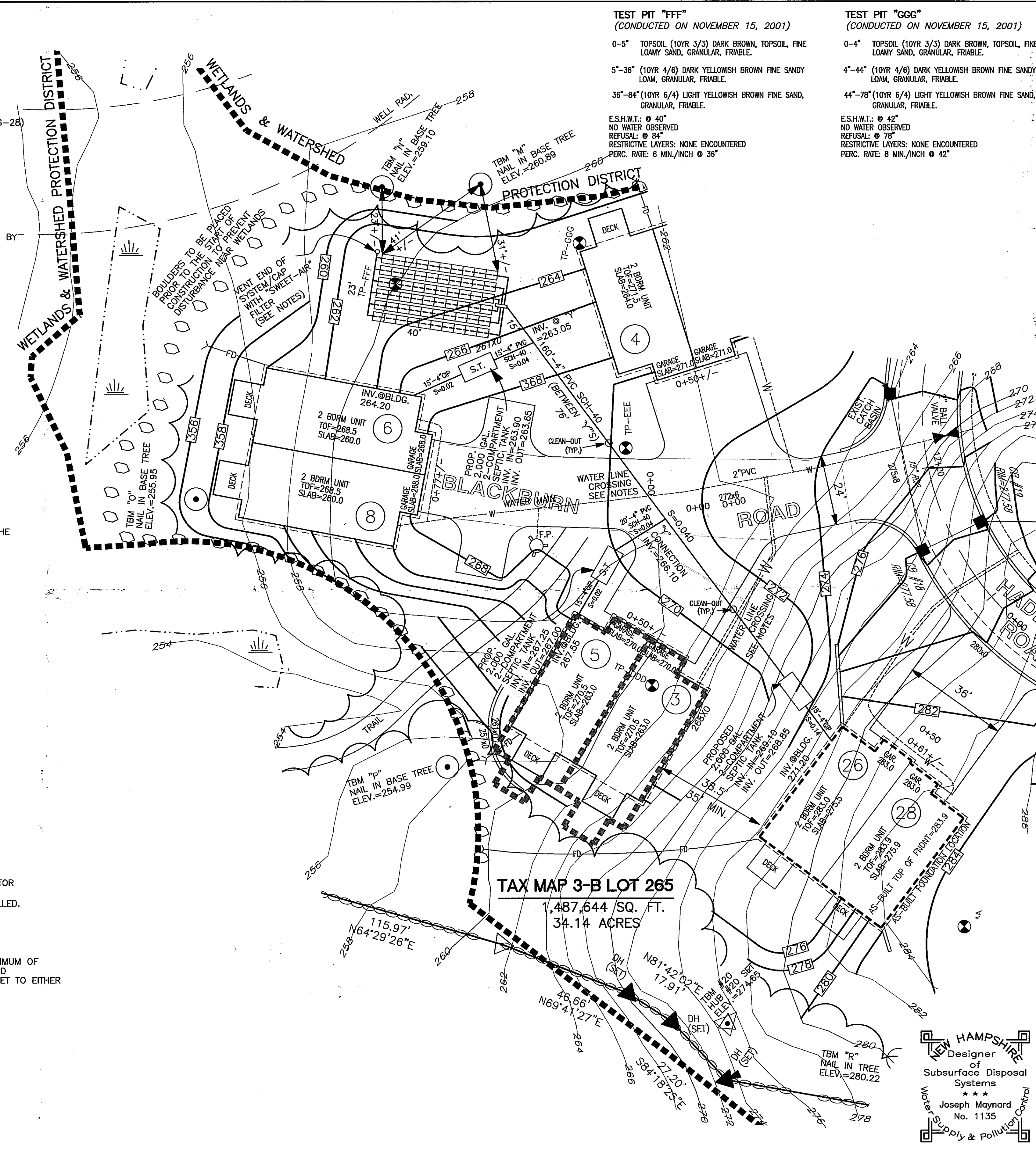

**TEST PIT "FFF"**  
(CONDUCTED ON NOVEMBER 15, 2001)

0-5" TOPSOIL (10YR 3/3) DARK BROWN, TOPSOIL, FINE LOAMY SAND, GRANULAR, FRIABLE.

5"-36" (10YR 4/6) DARK YELLOWISH BROWN FINE SANDY LOAM, GRANULAR, FRIABLE.

36"-84" (10YR 6/4) LIGHT YELLOWISH BROWN FINE SAND, GRANULAR, FRIABLE.

E.S.H.W.T.: @ 40"  
NO WATER OBSERVED  
REFUSAL: @ 84"  
RESTRICTIVE LAYERS: NONE ENCOUNTERED  
PERC. RATE: 6 MIN./INCH @ 36"

**TEST PIT "GGG"**  
(CONDUCTED ON NOVEMBER 15, 2001)

0-4" TOPSOIL (10YR 3/3) DARK BROWN, TOPSOIL, FINE LOAMY SAND, GRANULAR, FRIABLE.

4"-44" (10YR 4/6) DARK YELLOWISH BROWN FINE SANDY LOAM, GRANULAR, FRIABLE.

44"-78" (10YR 6/4) LIGHT YELLOWISH BROWN FINE SAND, GRANULAR, FRIABLE.

E.S.H.W.T.: @ 42"  
NO WATER OBSERVED  
REFUSAL: @ 78"  
RESTRICTIVE LAYERS: NONE ENCOUNTERED  
PERC. RATE: 8 MIN./INCH @ 42"

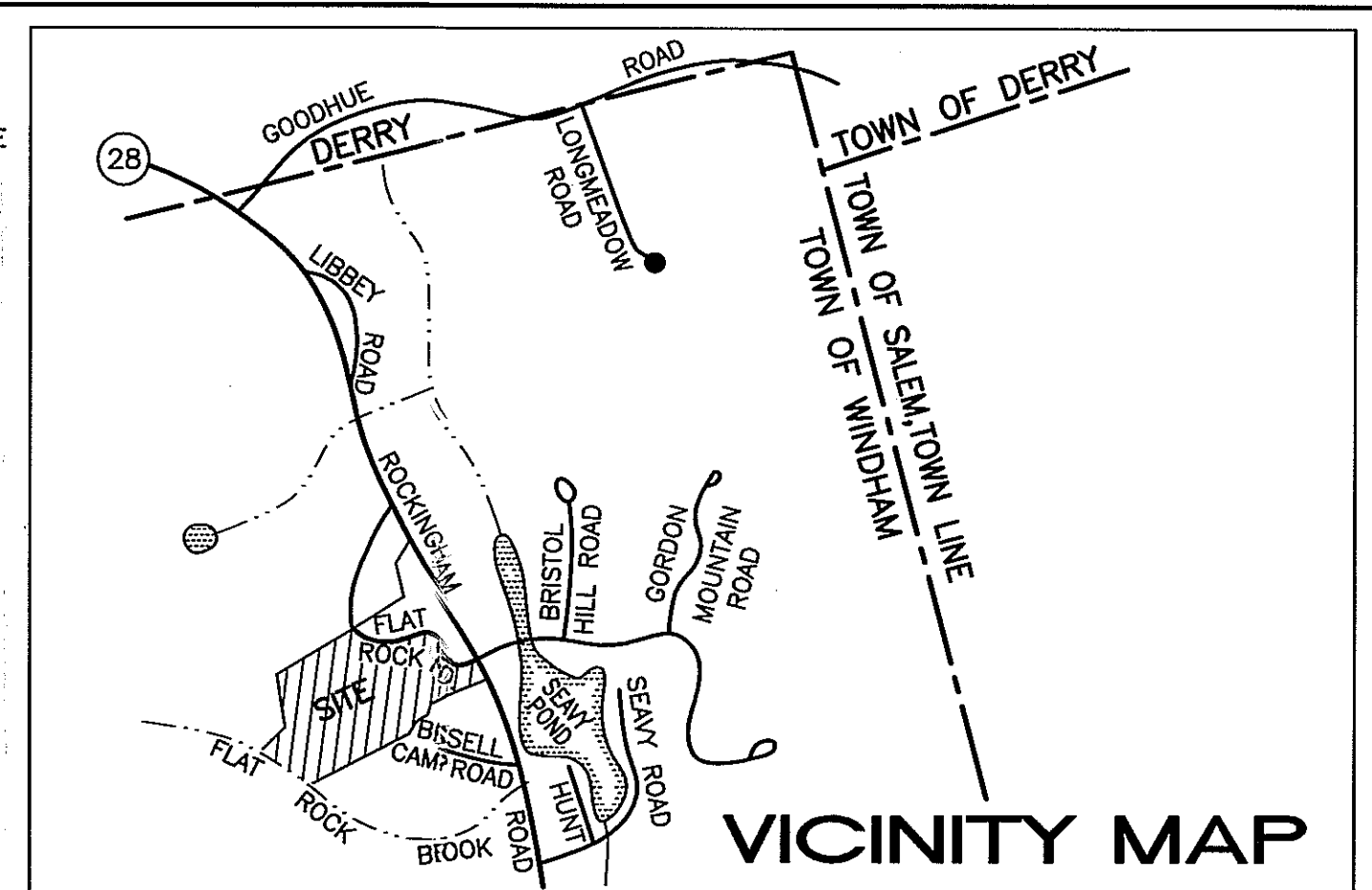

- PLAN REFERENCES:**
- SEE PLANS TITLED "SITE PLANS TAX MAP 3-B LOT 265 HADLEIGH WOODS WINDHAM, NEW HAMPSHIRE" OWNER: LOT 3-B-200 & 3-B-265 ADDRESS: 8 DEERWOOD HOLLOW CHESTER, NEW HAMPSHIRE 03036 SHEETS 1-15 OF 15 DATED MARCH 27, 2002 AS PREPARED BY THIS OFFICE.
  - SEE PLAN TITLED "SUBDIVISION PLAN TAX MAP 3-B LOT 200 & TAX MAP 3-B LOT 265 TAX MAP 3-B LOT 271 NH ROUTE 28 - ROCKINGHAM ROAD WINDHAM, NEW HAMPSHIRE 03087" OWNER: LOT 3-B-200 & LOT 3-B-265 H&B HOMES CORP. ADDRESS: 8 DEERWOOD HOLLOW CHESTER, NEW HAMPSHIRE 03036 OWNER: LOT 3-B-271 ANTHONY PETA ADDRESS: 30 BRANDYWINE COMMON DERRY, NEW HAMPSHIRE 03038 SHEETS 1-12 OF 12 DATED: MARCH 27, 2002 AS PREPARED BY THIS OFFICE.

**TAX MAP 3-B LOT 265**  
1,487,644 SQ. FT.  
34.14 ACRES

**SEPTIC SYSTEM PLAN**  
**TAX MAP 3-B LOT 265**  
**UNITS 3/5 & 6/8 BLACKBURN ROAD**  
**UNITS 26/28 HADLEIGH ROAD**  
**WINDHAM, NEW HAMPSHIRE 03087**  
OWNER OF RECORD/PREPARED FOR  
H&B HOMES CORP.  
8 DEERWOOD HOLLOW  
CHESTER, NEW HAMPSHIRE 03036  
R.C.R.D. BOOK 3575/PAGE 2759  
SCALE: 1"=20' SHEET 1 OF 2 APRIL 08, 2003

**NEW HAMPSHIRE**  
Designer  
of  
Subsurface Disposal  
Systems  
\*\*\*  
Joseph Maynard  
No. 1135  
Water Supply & Pollution Control

**BENCHMARK ENGINEERING, INC.**  
Consulting Engineers Land Planners  
10 Commons Drive, Suite 17  
Londonderry, New Hampshire 03053  
Phone: (603) 437-5000  
Fax: (603) 437-3078

REVISIONS	DATE

COPY FOR BRIAN